

MARGO



Margo is a modular ambient light in the form of a flower with independent petals. Designed for mounting in range, hanging, wall or post, its configurations are multiple depending on the number and size of petals chosen. Entirely composed of cast aluminum, its petals have 3 or 6 LEDs and provide asymmetrical or circular lighting. The power supply is placed at the foot of the pole to facilitate the maintenance of the luminaire. Equipped with an IP68 cable gland, Margo is IK10 and IP66. Each petal and petal door can be painted in any color to personalize the product.

* Regulation specific to France: Decree of 27/12/2018 relating to the prevention, reduction and limitation of light nuisance: product configuration to be defined according to the nature of the project.

19/03/2024 - All informations are subject to change without notice.





- ▶ 2 sizes of petals : Mega and Mini.
- ▶ Extremely modular: number of petals, with or without LEDs, lifted or suspended fixing, mix between Mega and Mini petals.
- ▶ Top mounted, suspended, against a pole or wall-mounted.

MARGO

LUMINAIRE'S SPECIFICATIONS

Luminaire's body

Top mounted or suspended

	MINI 4P 180° 12 LED	MINI 4P 360° 12 LED	MINI 8P 360° 24 LED	MEGA 4P 180° 24 LED	MEGA 4P 360° 24 LED	MEGA 8P 360° 24 LED	MEGA 8P 360° 48 LED	MIX 5P 225° 24 LED	MIX 8P 360° 36 LED
Weight	6 kg		10 kg	9 kg		11 kg	14 kg	10 kg	12 kg
Aerodynamic coefficient (CxS)	0.020 m²			0.028 m²					

Wall-mounted or against a pole

	MINI 1P 3 LED	MINI 4P 180° 12 LED	MINI 4P 180° 12 LED	MEGA 4P 180° 12 LED	MEGA 4P 180° 24 LED
Weight	1 kg	6 kg	10 kg	9 kg	14 kg
Aerodynamic coefficient (C _x S)	0.020 m²			0.028 m²	
Protection index	IP66				
Shock resistance	IK10				
Materials	Aluminium				

Operating temperature: -40°C to +35°C (up to +50° under conditions).

Standard color: Sanded Grey 2900

Individually removable petals

Easy to fit in the continuity of a Ø 76 mast with Ø 60 sleeve

Optical unit & control gear

From 3 to 48 LED - From 400 to 12200 lm (see attached Margo datasheet for details on power, light intensity and photometry available). Smart driver at the foot of the pole (control, automatic adjustment, CLO, graduation via voltage variation or DALI). ULR 1.6% (ULR: Upward Light Ratio).

Electric class

I and II



Customization



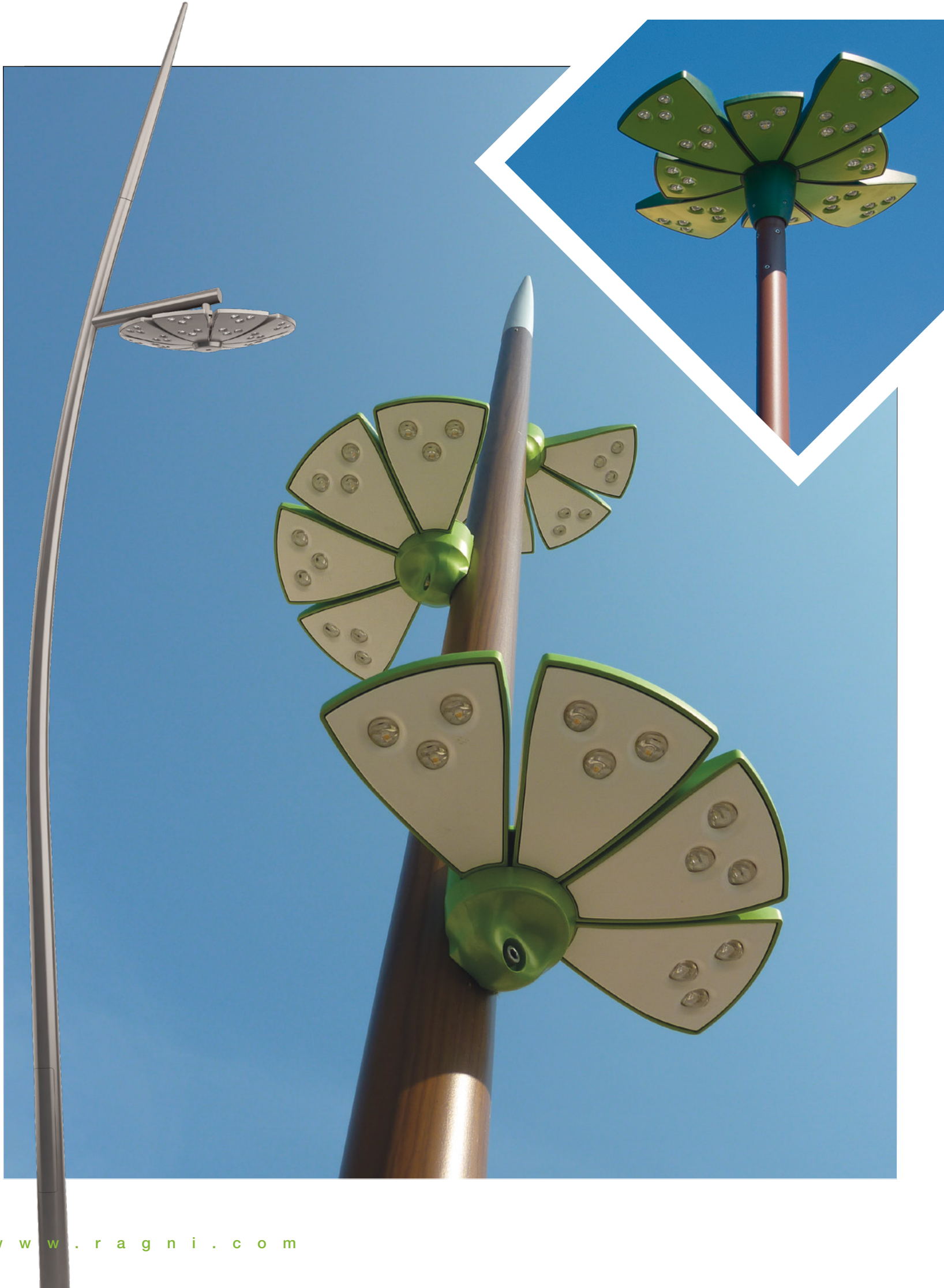



MARGO MEGA Dimensions (mm)

AMBIANCE - RESIDENTIAL | MARGO

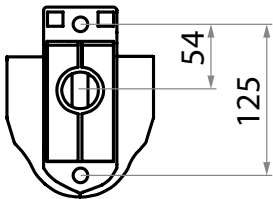
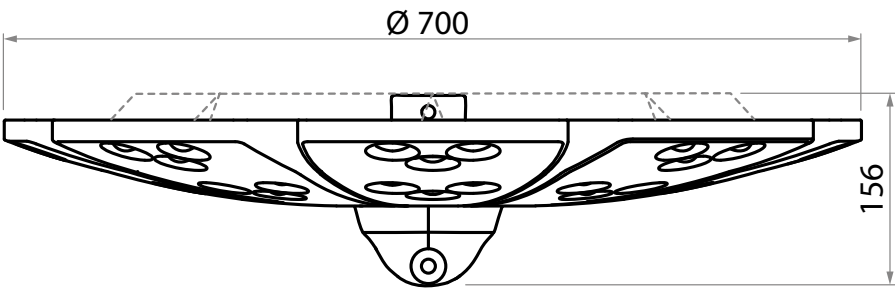
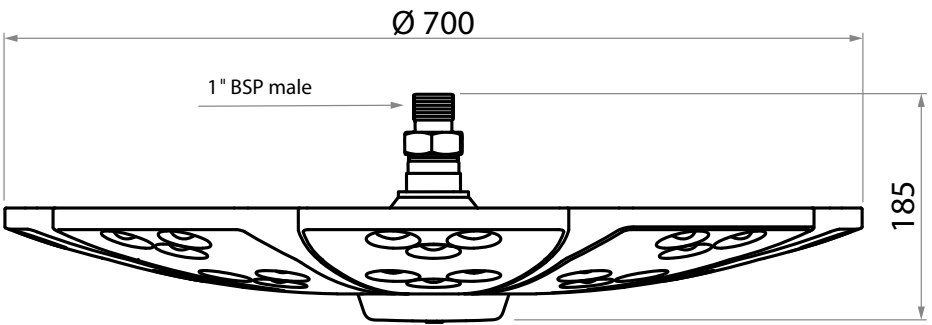
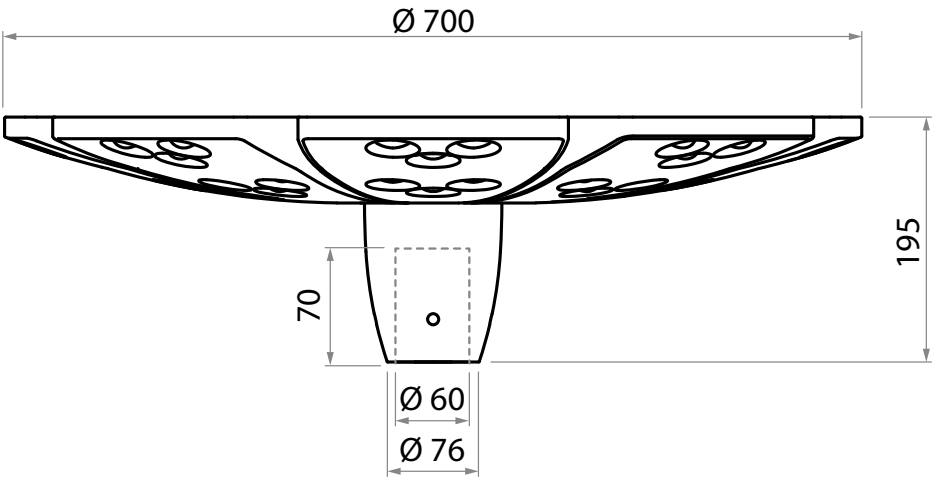

19/03/2024 - All informations are subject to change without notice.



www.ragni.com

MARGO MINI Dimensions (mm)

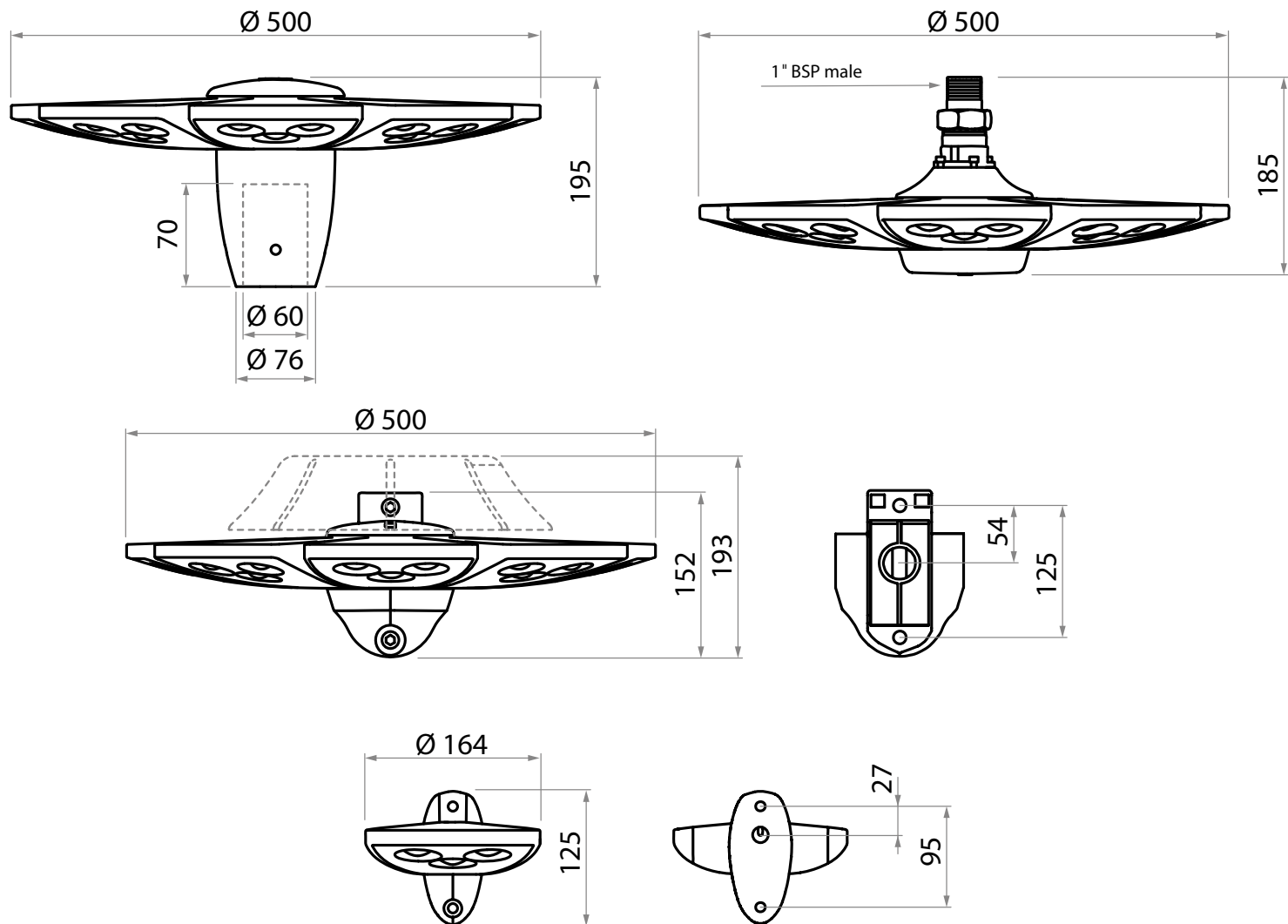

Options

- Surge protector

Ecodesign

Luminaire designed in compliance with the environmental criteria of energy efficiency, recyclability and interoperability.

Member of the Global Compact since 2018, Ragni is committed to working towards the 17 Sustainable Development Goals (SDG 11, 12, 13, 15).

Luminaire guaranteed free of hazardous substances.

Luminaire eligible for the energy savings certificate.

Luminaire compliant with the decree of 27/12/2018 on the prevention, reduction and limitation of light pollution: product configuration to be defined according to the nature of the project.



Applicable standards

IEC/EN 60598-1 / IEC/EN 60598-2-3 / NF EN 60529 / NF EN 62262 / IEC/EN 55015 / IEC/EN 61547 / IEC/EN 61000-3.2 / IEC/EN 61000-3.3 / IEC/EN 62493 / IEC/EN 62031 / IEC/EN 62471 / IEC/EN 61347-1 / IEC/EN 61347-2-13 / NF EN 13201-3 / NF EN 13201-4 / EN 13032-1+A1 & EN 13032-4 / LM79 / NF EN 12981

19/03/2024 - All informations are subject to change without notice.

Margo & urban furniture range design by Mauro Belli

Ensemble composition:

- Any top-mounted Margo.
- One or more intertwined pole(s) (different heights and curves).
- Possibility of combining the ensemble with urban furniture of the flowerpot or bench type.

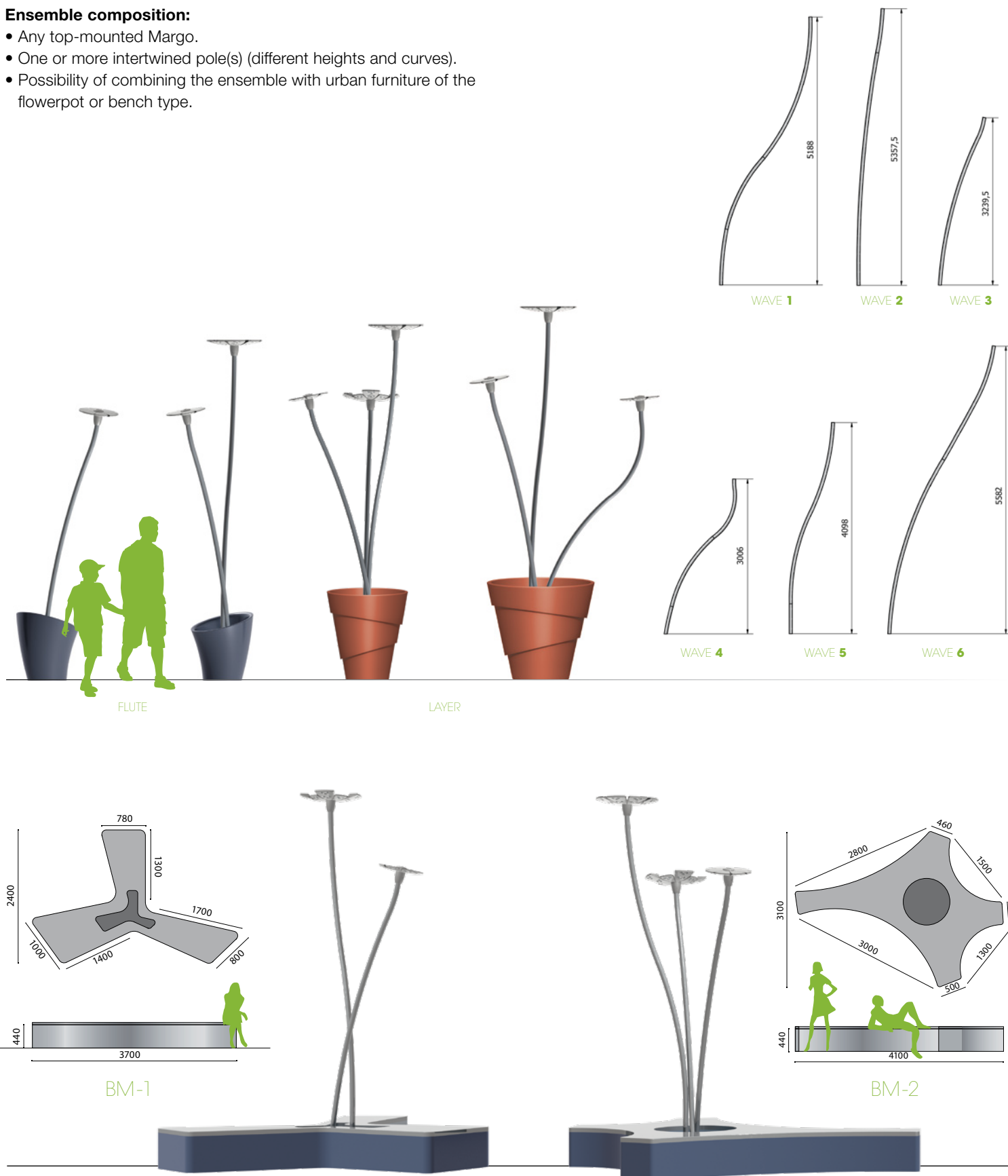



Sets proposals

- **Standard color:** Sanded grey 2900
- **Option:** other colors on request.

10m

8m

6m

4m

2m

A1 MARGO MEGA
wall-mounted
or against a pole

A1 MARGO MINI
wall-mounted
or against a pole

Bollard Sekoya

For coordinated projects,
Sekoya uses Margo petals
on a Ø 200 mm mast to create
a bollard ranging
from 670 to 4400 mm high.



B | MOODUL 350



C | HARMO 400 double bend



D | HARMO 600 double bend

MARGO

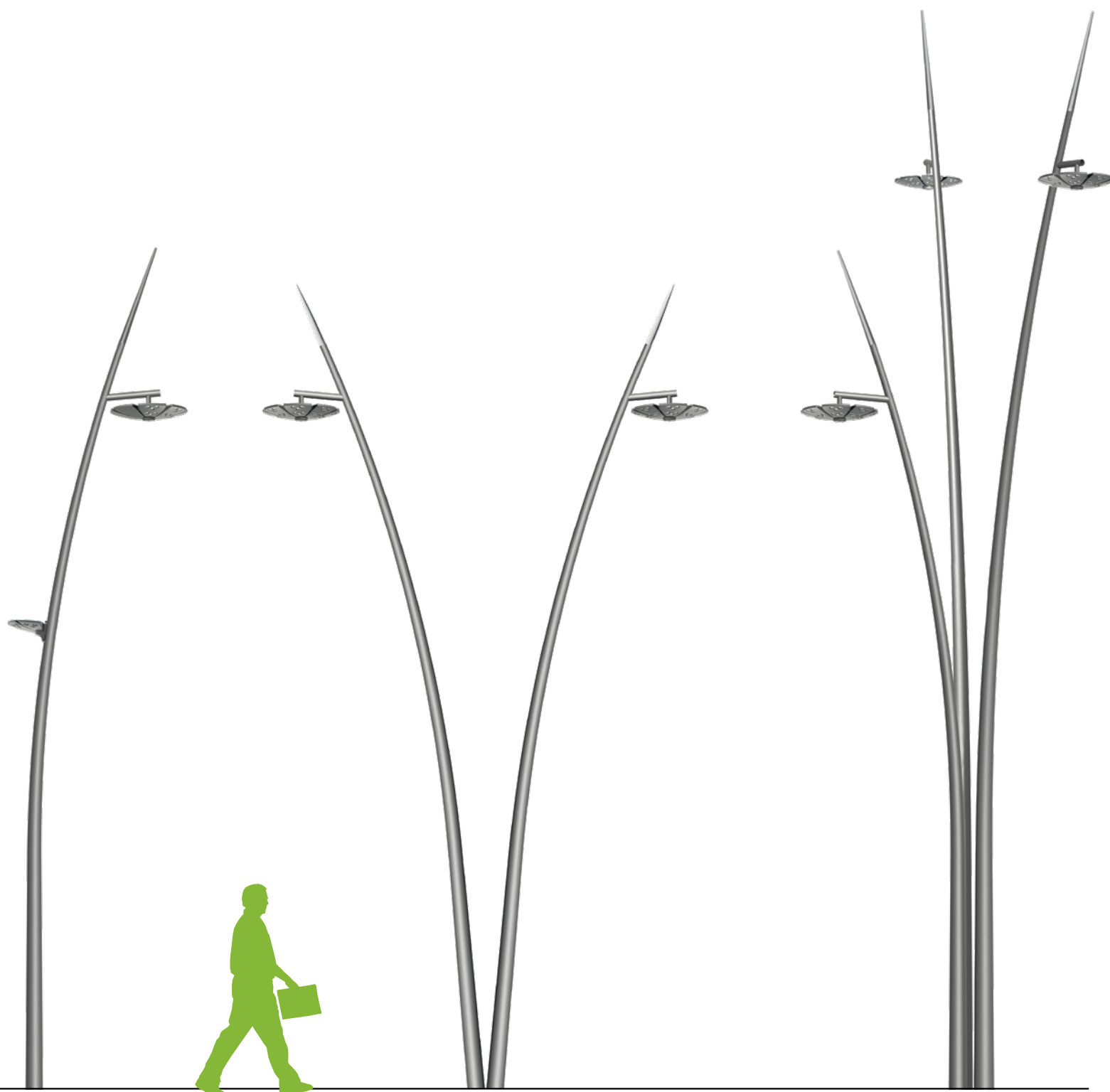

E | UNIA 600 - decorative tip

G | IRO 600 x2 - decoled tip

H | Bouquet UNIA 600-800
decoled tip

AMBIANCE - RESIDENTIAL | MARGO