

TIGÉA

BOLLARDS & COLUMNS | TIGÉA



- ▶ Available in 4 sizes:
from 3.5 to 5 m.
- ▶ Easy installation and maintenance.

*Regulation specific to France: Decree of 27/12/2018 relating to the prevention, reduction and limitation of light nuisance: product configuration to be defined according to the nature of the project.

04/07/2023 - All informations are subject to change without notice.

Cylindrical column with minimalist design, Tigéa is particularly suitable for lighting lively places such as squares, parks, pedestrian walkways but also with all types of modern architecture. Available in 4 sizes, the column is composed of an IK10 aluminum body and a transparent polycarbonate cover of cylindrical in shape,. A column head made of aluminum, covers the protection.

Electric class I and II, the column is equipped with a 8 LED circular module with an integrated cooling system. This module and allows, via a wide range of color temperatures and photometries, to precisely meet the lighting needs of the project. The column is painted by thermolacquering in a color of your choice. On request, the electronic gear cover can be painted in a different colour from the body.



TIGÉA

BOLLARD'S SPECIFICATIONS

Bollard's body & control gear

	TIGÉA 3500	TIGÉA 4000	TIGÉA 4500	TIGÉA 5000
Weight	29 kg	32.5 kg	36.2 kg	39.9 kg

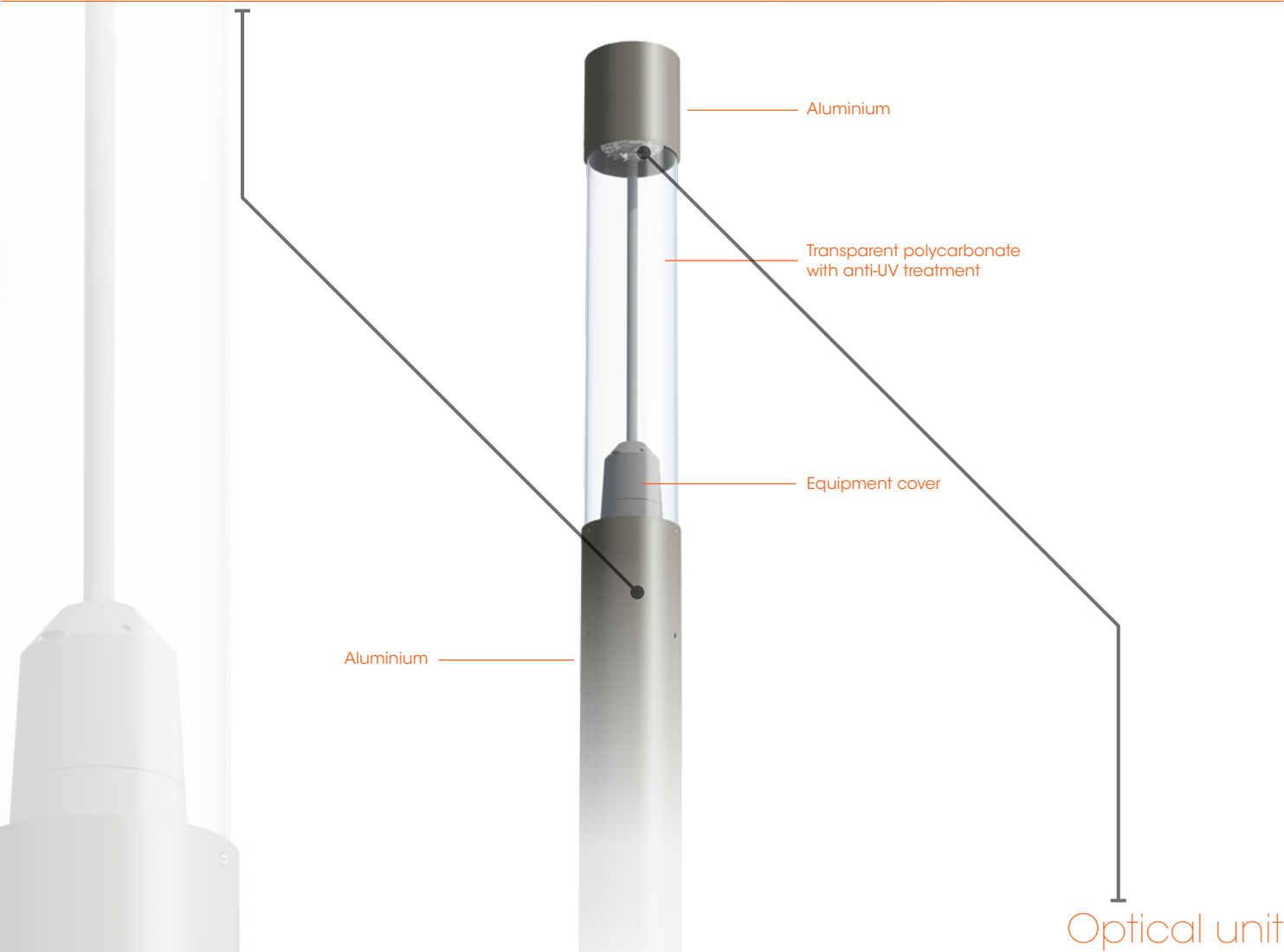

8 LED PCB - From 2000 to 4500 lm (see attached Acuisens V2 datasheet for details on power, light intensity and photometry available). Integrated smart driver (control, automatic adjustment, CLO, graduation via voltage variation or DALI). ULR < 1% (ULR: Upward Light Ratio).

Electric class	I and II
Protection index	IP65
Shock resistance	IK10

Operating temperature: -40°C to +35°C (up to +50° under conditions).

04/07/2023 - All informations are subject to change without notice.

Dimensions (mm)

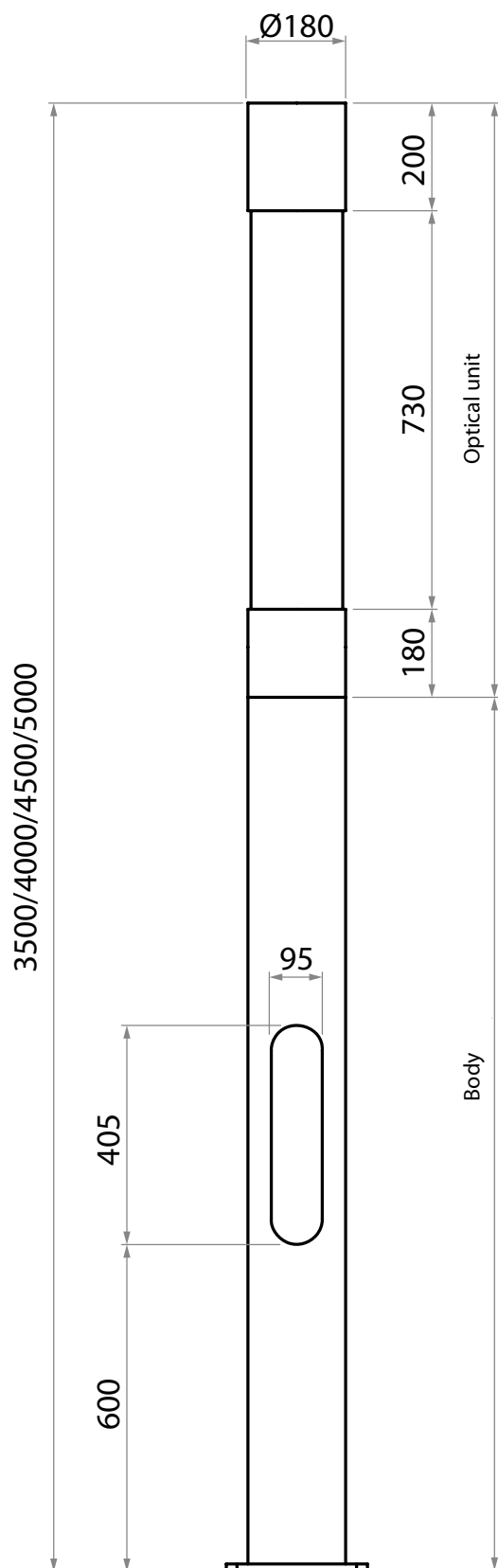

Options

- Surge protector.
- Presence detector.
- Sublimation (wood decorations Walnut, Kentucky, Elm or Pine) of the bollard body.

Ecodesign

Luminaire designed in compliance with the environmental criteria of energy efficiency, recyclability and interoperability.

Member of the Global Compact since 2018, Ragni is committed to working towards the 17 Sustainable Development Goals (SDG 11, 12, 13, 15).

Luminaire guaranteed free of hazardous substances.

Luminaire compliant with the decree of 27/12/2018 on the prevention, reduction and limitation of light pollution: product configuration to be defined according to the nature of the project.



Applicable standards

IEC/EN 60598-1 / IEC/EN 60598-2-3 / NF EN 60529 / NF EN 62262 / IEC/EN 55015 / IEC/EN 61547 / IEC/EN 61000-3.2 / IEC/EN 61000-3.3 / IEC/EN 62493 / IEC/EN 62031 / IEC/EN 62471 / IEC/EN 61347-1 / IEC/EN 61347-2-13 / NF EN 13201-3 / NF EN 13201-4 / EN 13032-1+A1 & EN 13032-4 / LM79 / NF EN 12981

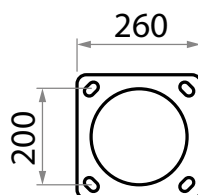

4 anchor bolts M14/Ø16x300 (not supplied)

Recommended plinth dimensions:

DROM: 0,5 m x 0,5 m x 0,7 m

France: 0,4 m x 0,4 m x 0,5 m

Aesthetic proposals

- **Standard color:** Sanded grey 2900.
- **Option:** other colors on request.

TRAITEMENT SPÉCIAUX :

Wood decor

Walnut

Kentucky

Elm



Pine

4m

2m

BOLLARDS & COLUMNS | TIGÉA

A |  RAL 7024

B | **HEAD**
 RAL 9003
BODY
 RAL 7040

C |  RAL 6034

TIGÉA



D | **HEAD**
■ Sanded grey 2900
BODY
■ Walnut wood decor



E | ■ RAL 3022



F | ■ RAL 1011

