

Installation raccord union 1" GAZ Mâle

1

Dévisser l'embout
Unscrew the connector

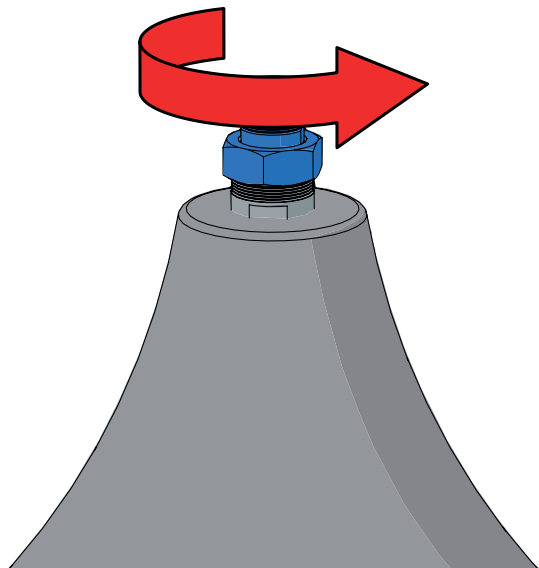

2

Mettre l'embout dans la crose puis
serrer avec la clef 38.
Put the connector inside the bracket
and tighten with the 38 key.

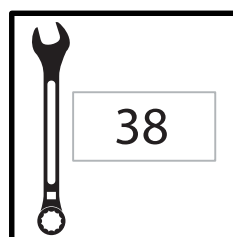

Threadlocker

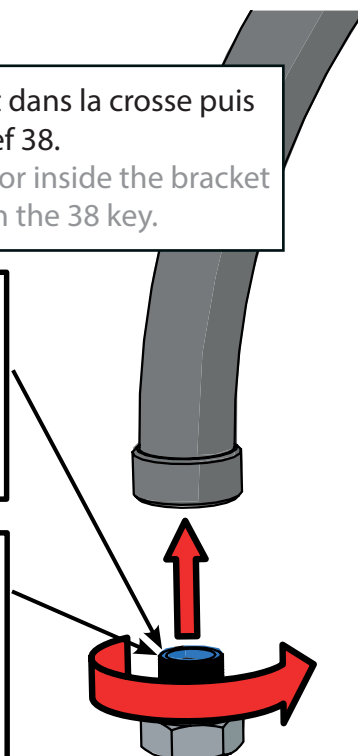

3

Couple de serrage
Tightening torque
32 N.m

Serrer
Tighten

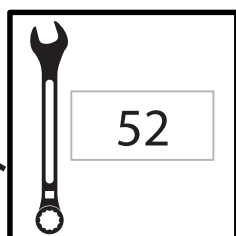

Maintenir
Hold

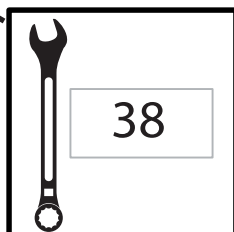

Attention orientation luminaire
Be careful with the orientation of
luminaire

**Ne surtout pas tourner le luminaire
lors du serrage. (risque de destruction du
joint)
Aucune garantie ne sera prise en charge en
cas d'infiltration d'eau suite au non respect de
cette consigne de montage.**

**Do not turn the light when tightening. (risk of
destruction of the seal)
No guarantee will be taken in case of water
infiltration due to non-compliance with this
assembly instruction.**